

- 45MM CONSOLIDATED 14MM DBM 125PEN CLOSE GRADED SURFACE COURSE PSV65 BS4987 (AC 14 CLOSE GRADED SURF 100/150 PSV60 HS EN13108-1) (TO BE LAID BY MACHINE)
- 50MM CONSOLIDATED (20MM) SIZE DENSE DBM 100PEN BINDER COURSE TO BS 4987 PART 1 TABLE 6.5 (TO BE LAID BY MACHINE)
- 150MM OF (28MM) SIZE DENSE ROAD BASE TO BS 4987 (100 PEN BITUMEN) TO CLAUSE 903 SPECIFICATION FOR HIGHWAY WORKS (TO BE LAID BY MACHINE IN TWO LAYERS OF 75MM)
- TYPE 1 GRANULAR SUB BASE (CLAUSE 803) THICKNESS SUBJECT TO CBR VALUE DETERMINED ON SITE. SEE TABLE FOR REQUIRED THICKNESS.
- CAPPING LAYER SUBJECT TO CBR VALUE (CLAUSE 613)

CBR VALUE	BELOW 3%	3% - 5%	ABOVE 5%
SUB BASE	300mm	300mm	200mm
CAPPING LAYER	300mm	0mm	0mm

CARRIAGEWAY DETAIL
SCALE 1:10

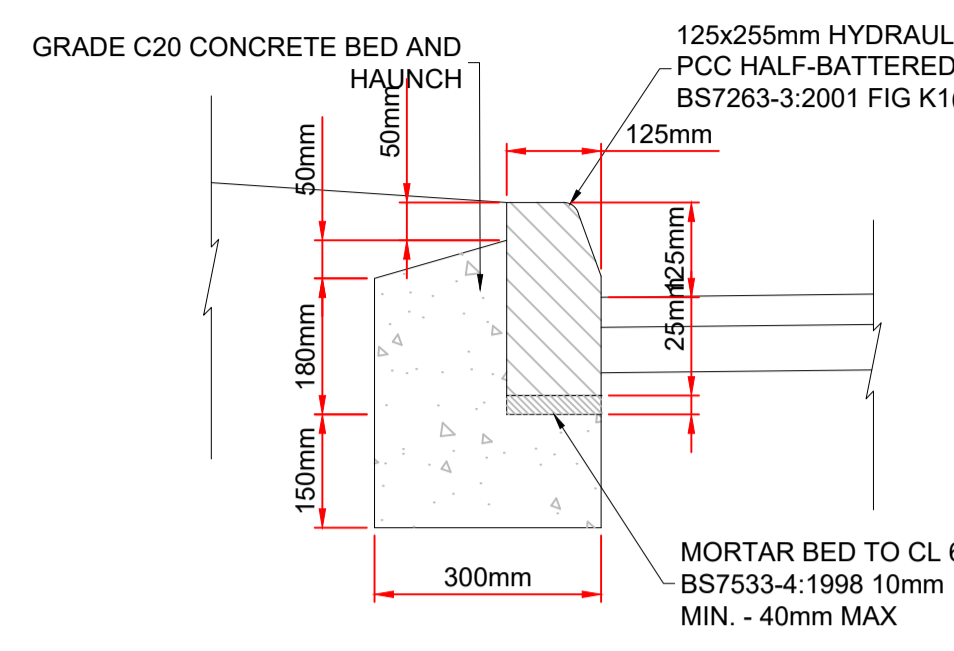

HB2 KERB DETAIL
SCALE 1:10

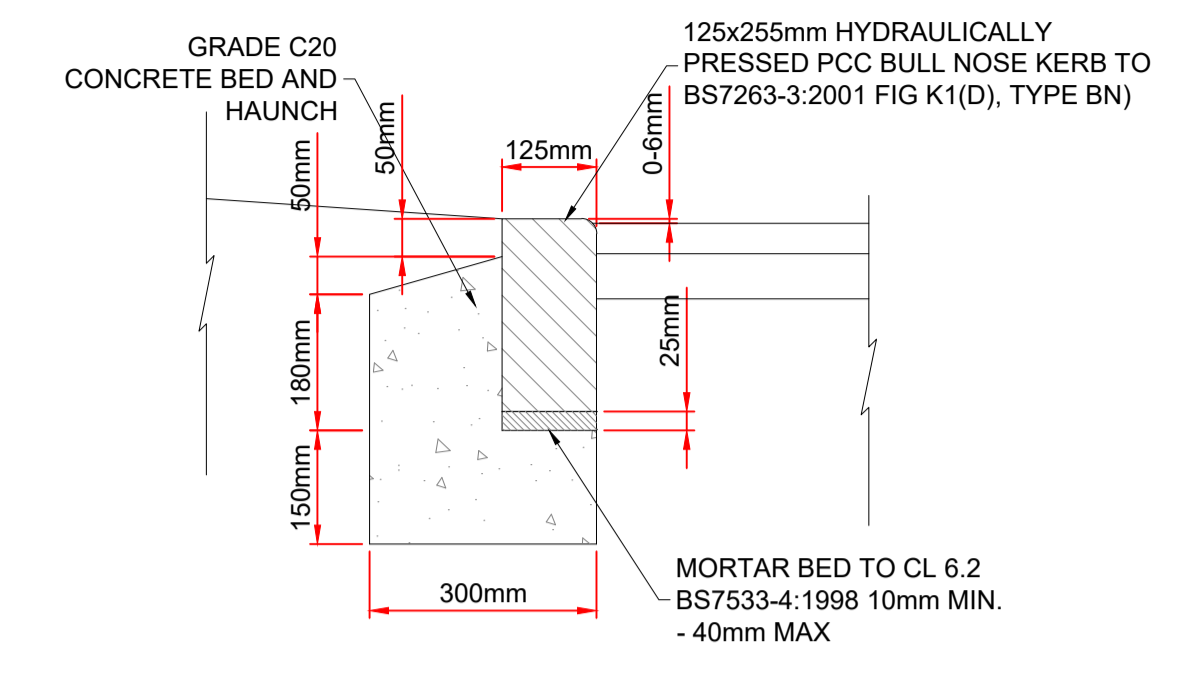

BN KERB DETAIL
SCALE 1:10

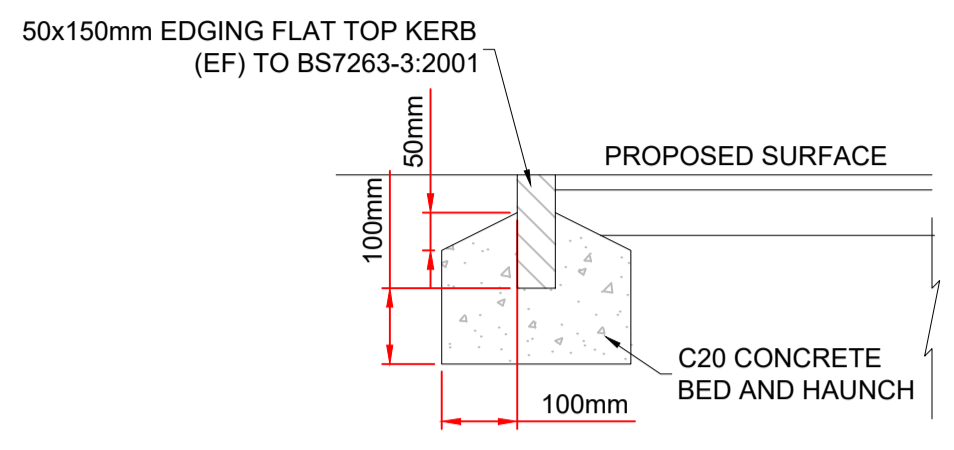

EF KERB DETAIL
SCALE 1:10

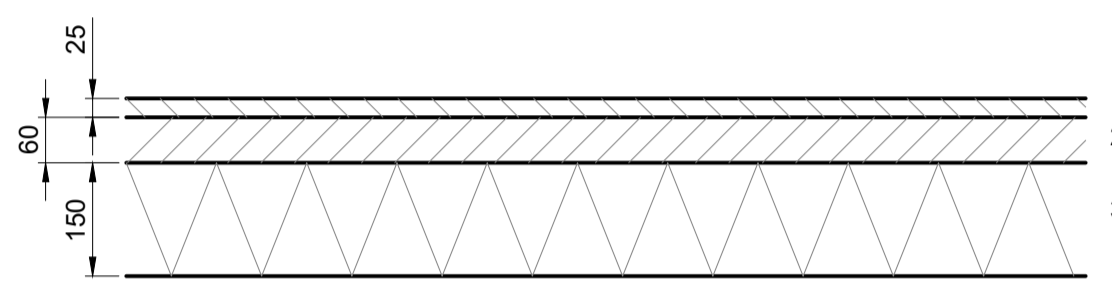

FOOTPATH DETAIL
SCALE 1:10

- 25mm CONSOLIDATED THICKNESS DENSE GRADED MACADAM WEARING COURSE. 6mm NOMINAL AGGREGATE SIZE. 200 PEN BITUMEN. (B.S. 4987 PART 1, EN 13108, PART 1)
- 60mm CONSOLIDATED THICKNESS DENSE MACADAM BASE COURSE. 20mm NOMINAL AGGREGATE SIZE. 100 PEN BITUMEN. (BS 4987 PART 1, EN 13108, PART 1). (CLAUSE 906)
- 150mm CONSOLIDATED THICKNESS GRANULAR SUB BASE TYPE 1 TABLE 8/2 AND CLAUSE 803 (SPEC. FOR HIGHWAY WORKS)

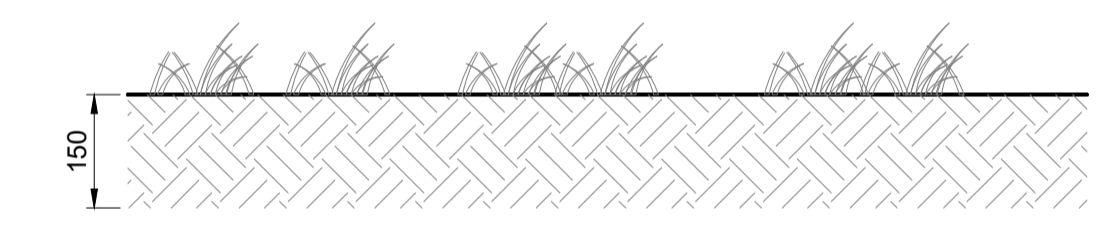

LANDSCAPING DETAIL
SCALE 1:10



- AREA TO BE REGULATED WITH BASE COURSE MATERIAL EITHER AS AN INDEPENDENT OPERATION OR AS A RESULT OF INCREASING THE OVERLYING LAYER THICKNESS WITHIN TOLERANCES
- EXISTING SURFACE TO BE COATED WITH BITUMINOUS SPRAY, TYPE A1-40 OR K1-40 AT A RATE OF SPREAD OF 0.3 TO 0.5 LITRES/SQ.m. ROADBASE BEING LAID IN TWO LAYERS TO BE REGULATED OVER LENGTH SHOWN WITH BASE COURSE MATERIAL.
- EXISTING SURFACE TO BE PLANED AS SHOWN TO A DEPTH OF THE NEW WEARING COURSE AND DEPTH OF NEW BASE COURSE. PLANED SURFACES TO BE COATED WITH BITUMINOUS SPRAY, TYPE A1-40 OR K1-40 AT A RATE OF SPREAD OF 0.3 TO 0.5 LITRES/SQ.m.

ROAD TIE IN DETAILS
NOT TO SCALE

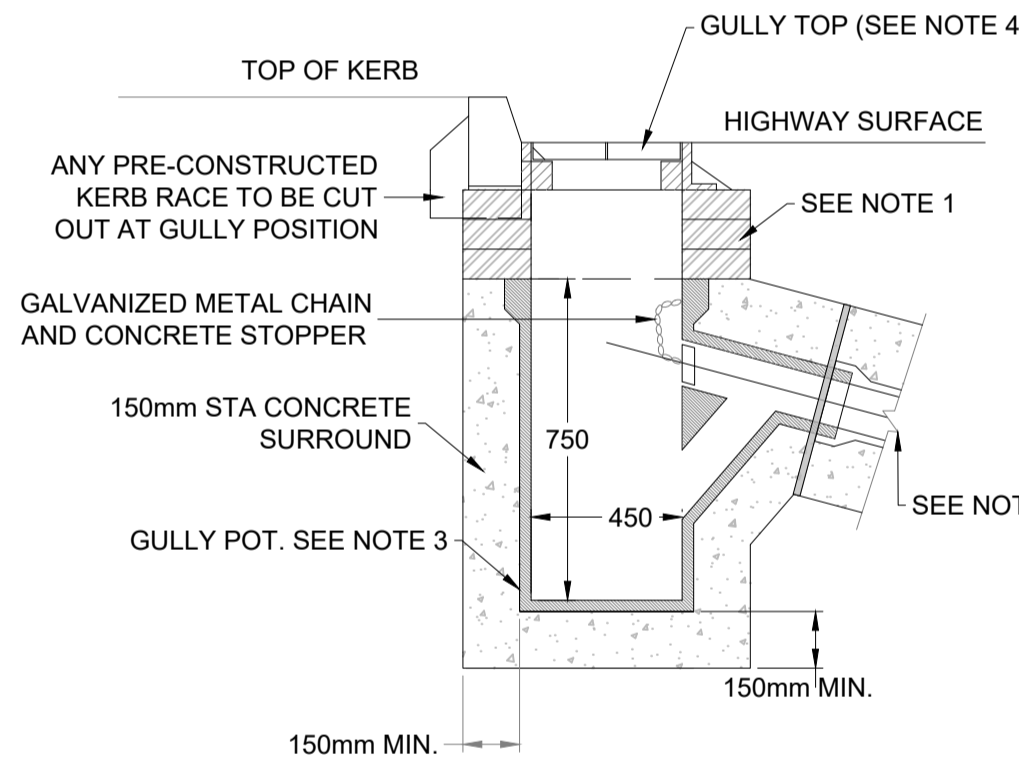

ROAD GULLY DETAIL
(TRAPPED WITH SPIGOT OUTLET)

- NOTES:
- CLASS 'B' ENGINEERING BRICK TO BS 3921 OR CONCRETE BRICK TO B.S. 6073(1) HAVING A CRUSHING STRENGTH OF NOT LESS THAN 40N/mm². 3 COURSES ARE RECOMMENDED WITH A MINIMUM OF 2 AND A MAXIMUM OF 4.
 - 150mm DIA. OUTLET PIPE WITH 150mm THICK CONCRETE SURROUND DOWN TO DEPTH OF 1.2m COVER FROM FINISHED ROAD LEVEL TO TOP OF PIPE.
 - 450mm X 750mm DEEP CONCRETE GULLY TO B.S. 5911(2) WITH 150mm DIA. TRAPPED OUTLET OR CLAYWARE TO B.S. 65.
 - HEAVY DUTY GRATING AND FRAME, SINGLE PIECE HINGED (HINGE FACING TRAFFIC), NON ROCKING. CLASS D400 TO B.S. EN124. KITEMARKED. SET 5mm BELOW FINISHED ROAD LEVEL.
 - ALL DIMENSIONS ARE IN MILLIMETERS UNLESS OTHERWISE STATED.

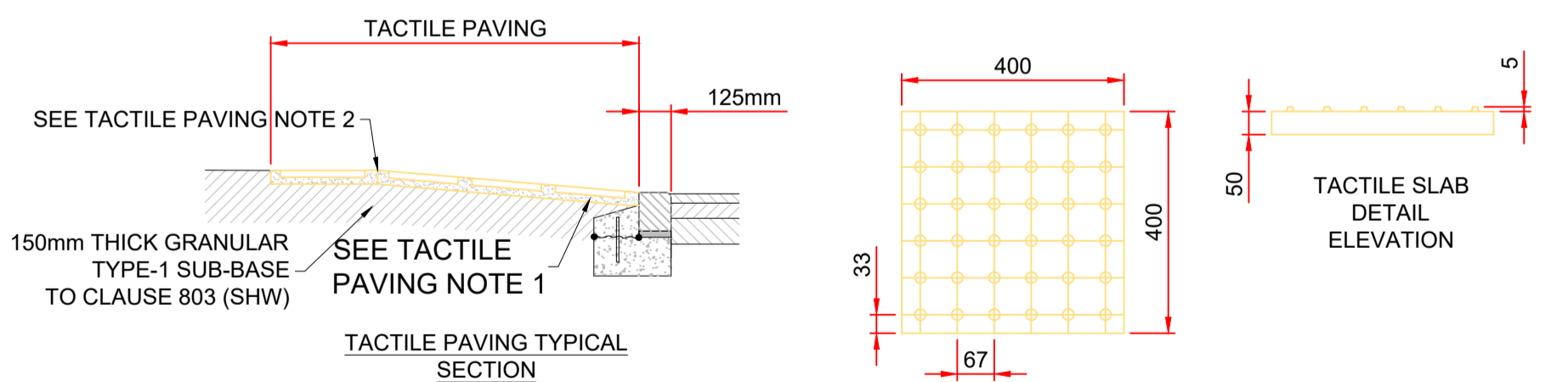

TACTILE PAVING NOTES

- THE TACTILE PAVING SLABS SHALL BE LAID ON A FULL BED OF MORTAR, IN THE PROPORTIONS OF 3:1 SAND:CEMENT. THE MORTAR THICKNESS WHEN COMPACTED SHALL NOT BE LESS THAN 25 MM. THE SLABS SHALL BE BEDDED DOWN USING A PAVIOURS MAUL.
- JOINTS SHALL BE FILLED WITH MOIST 4:3:1 SAND:CEMENT:MORTAR MIX TO WITHIN 2-3 MM OF THE TOP SURFACE.
- THE TACTILE PAVING SLABS SHOULD BE IN ACCORDANCE WITH B.S. 368.
- KERBS ARE TO BE FLUSH WITH THE ROAD SURFACE.
- EXACT CONFIGURATION OF EACH CROSSING TO BE IN ACCORDANCE WITH DOT CIRCULAR 1/97 AND IS TO BE AGREED ON SITE WITH THE ENGINEER.

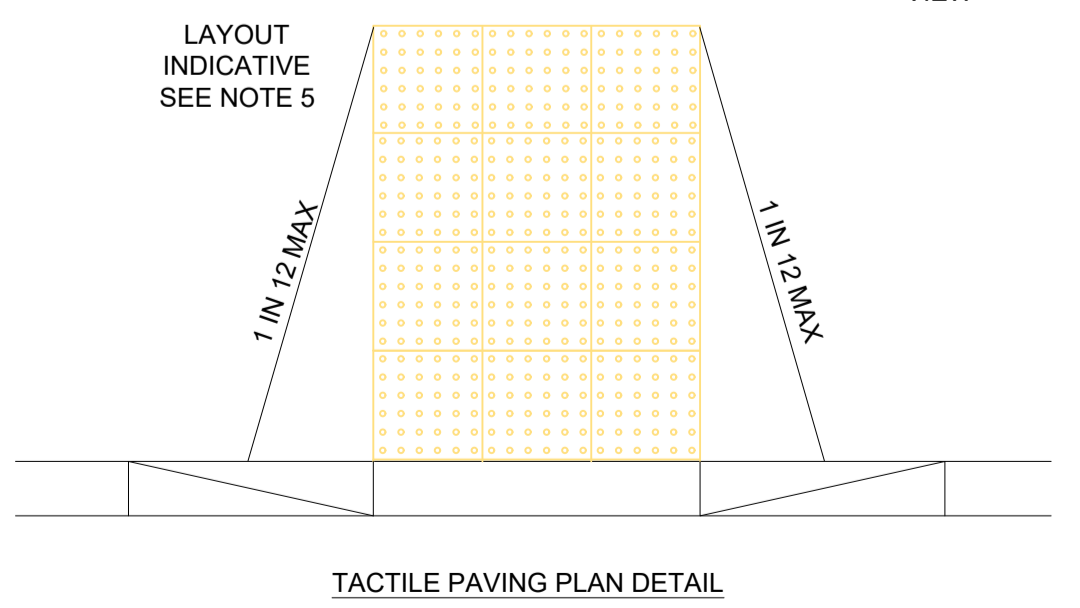

TACTILE PAVING PLAN DETAIL

TYPICAL ROAD MARKING ARRANGEMENTS

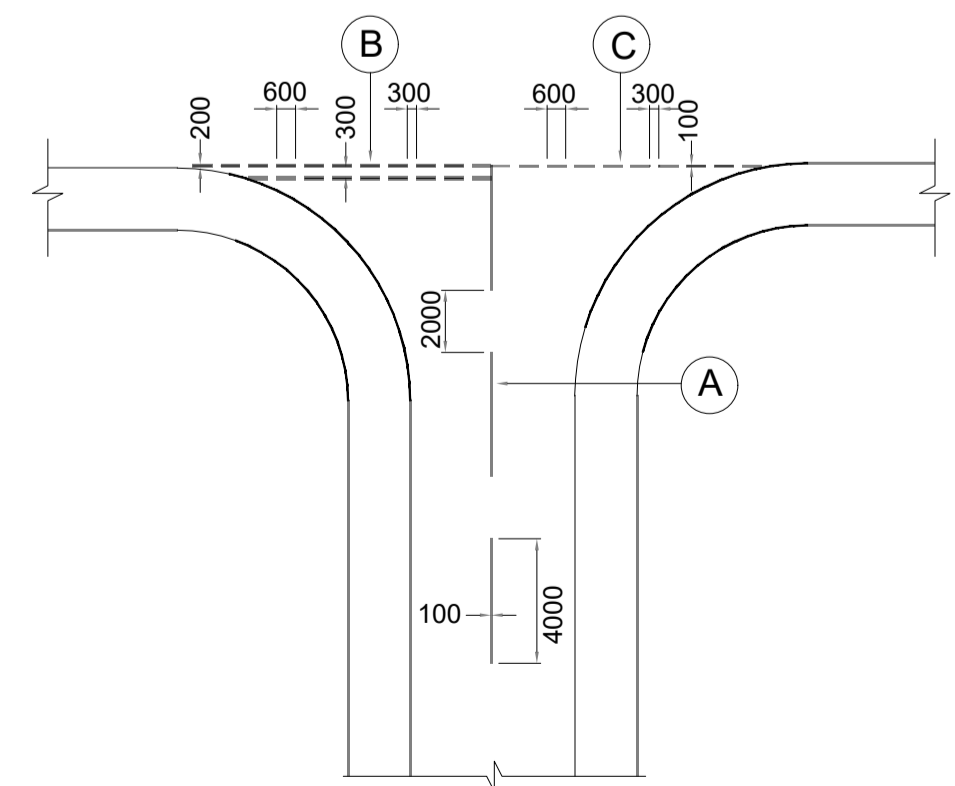

- KEY
- A. MINIMUM OF 3 NUMBER MARKINGS OR AS SPECIFIED BY THE HIGHWAY AUTHORITY. WHITE 4m MARK, 2m GAP, 100mm WIDE. TSRGD DIAG. NO. 1004.
 - B. WHITE 600mm MARK, 300mm GAP, 200mm WIDE TSRGD DIAG. NO. 1003.
 - C. WHITE 600mm MARK, 300mm GAP, 100mm WIDE TSRGD DIAG. NO. 1009.
- NOTES
- ALL MARKINGS TO BE OF THERMOPLASTIC SPARY OR SCREED WITH APPLIED SOLID GLASS BEADS AND DESIGNED IN ACCORDANCE WITH CHAPTER 5 OF THE TRAFFIC SIGNS MANUAL (H.M.S.O.), AND
 - ALL DIMENSIONS ARE IN MILLIMETRES UNLESS OTHERWISE STATED.

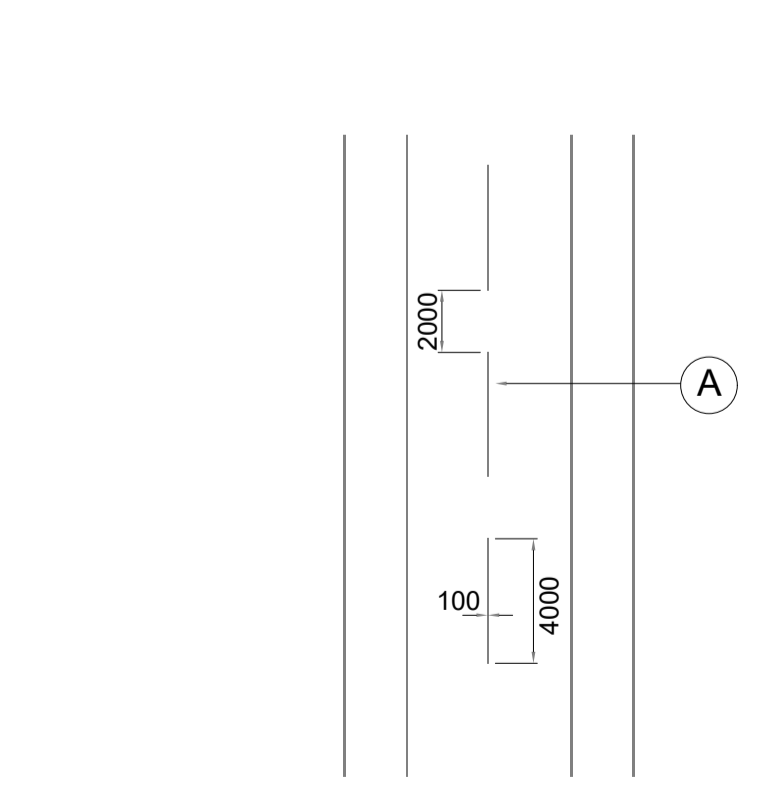

- KEY
- A. MINIMUM OF 3 NUMBER MARKINGS OR AS SPECIFIED BY THE HIGHWAY AUTHORITY. WHITE 4m MARK, 2m GAP, 100mm WIDE. TSRGD DIAG. NO. 1004.
- NOTES
- ALL MARKINGS TO BE OF THERMOPLASTIC SPARY OR SCREED WITH APPLIED SOLID GLASS BEADS AND DESIGNED IN ACCORDANCE WITH CHAPTER 5 OF THE TRAFFIC SIGNS MANUAL (H.M.S.O.), AND
 - ALL DIMENSIONS ARE IN MILLIMETRES UNLESS OTHERWISE STATED.

REV	DESCRIPTION	BY	DATE
FOR APPROVAL			

CDGray
 CIVIL & STRUCTURAL ENGINEERS
 5-6 Deryn Court, Wharfedale Road, Pentwyn, Cardiff, CF23 7HB
 Tel: 02920 733181
 Web: www.cdgray.co.uk

client **ENZO HOMES**

project **HEOL Y GLYN GYLNNEATH**

drawing title **SECTION 278 CONSTRUCTION DETAILS**

drawn GJ	chd RE	project no. 9610
date drawn 26.10.2020	sig no. 106	rev. P1
scale AS STATED		